

NEXT-GEN CAMPUS MASTER PLAN

EXECUTIVE SUMMARY



TRANSFORMING KANSAS STATE UNIVERSITY'S CAMPUS FOR THE FUTURE

As I reflect on Kansas State University's remarkable journey since our founding in 1863 as America's first operational land-grant university, I am filled with pride in our heritage and excitement for our future. The Next-Gen Campus Master Plan honors that legacy while charting a bold path forward — reimagining our physical spaces to support innovation, collaboration and student success. It embraces our statewide mission by uniting our Manhattan, Salina and Olathe campuses with a shared purpose as we create new opportunities for students, faculty, staff and communities across Kansas and beyond.

Building for tomorrow's learners

We are transforming our facilities into dynamic learning environments that foster 21st-century education and discovery. Modern research spaces will position K-State as a leader in global challenges including health, food security and sustainability. Simultaneously, we honor our heritage by renovating historic buildings to meet today's needs while preserving K-State's distinctive character.

Promoting collaboration and partnerships

Our vision includes spaces that encourage interdisciplinary collaboration — where engineers, scientists and students from diverse fields work together to solve real-world problems and address our more significant challenges through community-driven research. Initiatives like the Agriculture Innovation Initiative and the Edge District will support public-private partnerships, connecting academic discovery with industry to create meaningful impact.

Enhancing student success

At the heart of our plan is an unwavering focus on student success. We are streamlining services and designing spaces that support the whole student. Every design decision centers on the student experience, ensuring that our campus not only educates but truly nurtures each individual.

Prioritizing well-being and social connections

We recognize that learning extends beyond classrooms into the spaces where our community connects. By enhancing areas like the Campus Creek, Anderson Lawn and Bosco Student Plaza with wellness features and programming, we're creating a campus that feels like home. These vibrant gathering spots — from outdoor classes to concerts — strengthen the bonds of our K-State Family.

Legacy of innovation

Aligned with our Next-Gen K-State strategic plan, this transformation positions us as the next-generation land-grant university. The benefits will extend far beyond campus, strengthening local economies and communities. As K-State grows and evolves, so will the vibrant communities surrounding us.

Moving forward together

This plan reflects the voices of thousands across our K-State Family. As we move from vision to action, we do so united in purpose — building not just a better campus, but a better future.

Go 'Cats!



Richard H. Linton

Richard H. Linton

President, Kansas State University



EXECUTIVE SUMMARY

The Next-Gen Campus Master Plan encompasses the Manhattan, Olathe and Salina campuses to pioneer a vision for future development as One K-State. This plan represents a forward-looking roadmap to guide K-State's physical evolution over the next decade.

The strategies introduced through this plan respond to institutional goals and will serve to shape the built environment, advancing academic excellence, research growth, innovation, and community well-being.

These transformations will propel us forward as the next-generational land-grant university.

PURPOSE & INTENT OF THE CAMPUS MASTER PLAN

The Next-Gen K-State Strategic Plan greatly influenced and inspired the Next-Gen Campus Master Plan, which builds upon each existing campus location to truly engage and align resources, opportunities, partnerships and investments.

Reinforcing Strategic Alignment & Optimization

The Next-Gen Campus Master Plan provides a strategic yet flexible physical development framework for planning and future growth, guiding decisions over the next decade and beyond as the university’s needs evolve. Guided by the One-K-State vision, the plan focuses on fostering more connected campuses through integrated planning principles, a unified vision and strategic development that enhances facility operations while supporting the goals of Next-Gen K-State.

Leveraging a Community Driven & Data-Informed Planning Process

The Next-Gen Campus Master Plan began in 2024 as an 18-month collaborative effort shaped by input from thousands of stakeholders. Ongoing data collection and research efforts, served to inform decisions and ensured alignment with university goals. Task forces organized around strategic themes helped develop principles to guide future choices. The process incorporated priorities and ideas from across K-State, which were further shaped by feedback from the Executive Leadership Team and the broader university community.

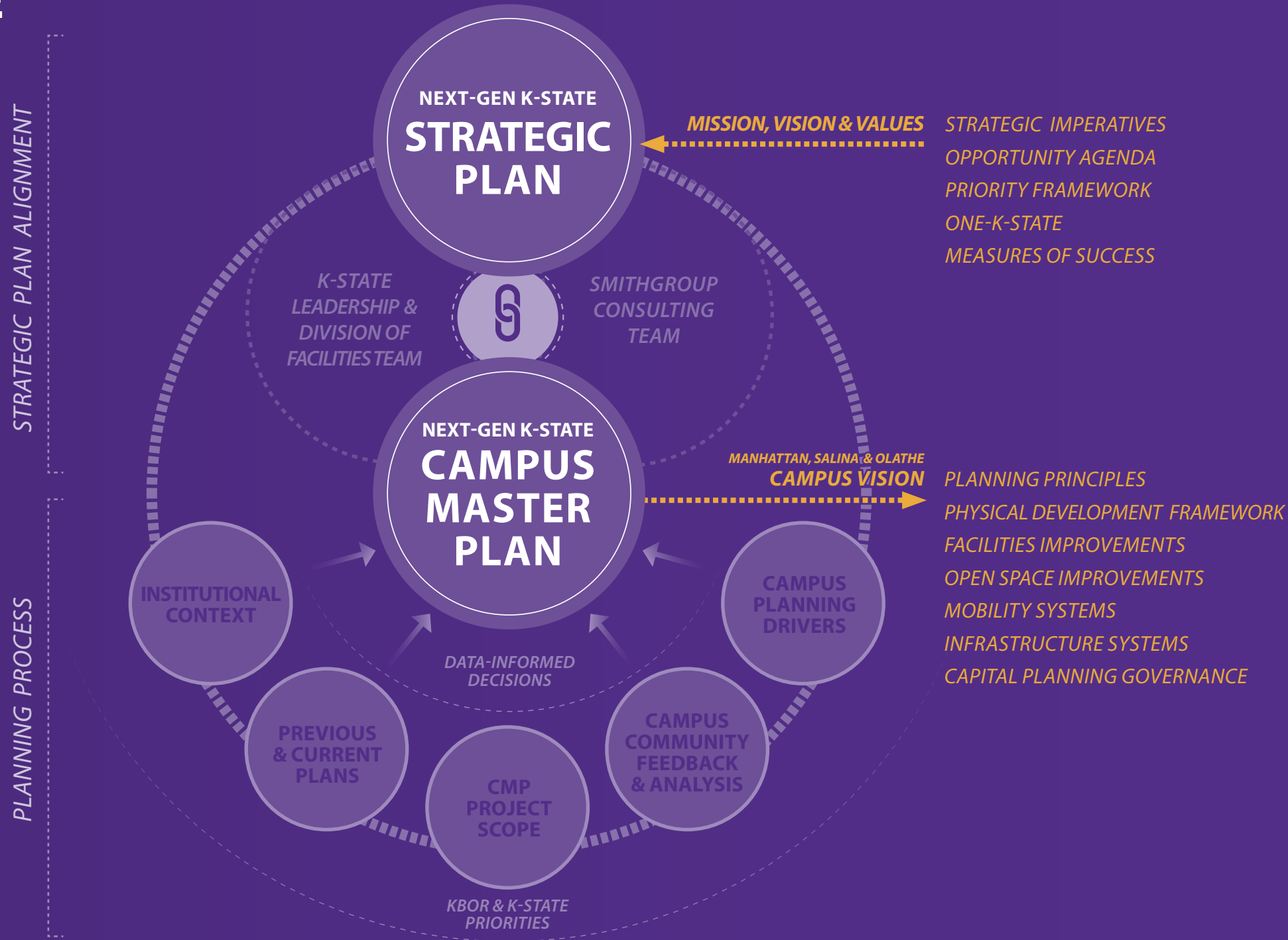

PLANNING PRINCIPLES

These principles guide key decisions and investments to ensure alignment with the K-State Next-Gen Campus Master Plan. They provide a clear, consistent framework for evaluating opportunities, setting priorities and balancing short-term needs with long-term goals for physical campus development.



EXPAND RESEARCH

- Strengthening research programs creates new opportunities for interdisciplinary discovery.
- Upgrading and expanding research facilities is essential to meet future goals and to fulfill our mission as a next-generation land-grant institution.
- Prioritizing research investments around the Next-Gen opportunity agenda themes will elevate the impact for addressing grand challenges through interdisciplinary discovery and scholarly development.



ENHANCE THE K-STATE EXPERIENCE

- Creating a truly memorable campus experience requires continual investment in designing spaces that inspire connection, pride and a strong sense of belonging.
- Prioritizing and enhancing the daily experience will enrich academics, research, and community life on every campus.



IMPROVE CONNECTIVITY

- Improve upon how people move through campus; improve pedestrian and vehicular safety; enhance ease of movement, access and efficiency.
- Improving circulation systems will foster co-location, collaboration across disciplines and create a more welcoming, intuitive experience.



TRANSFORM THE BUILT ENVIRONMENT

- Transforming K-State will require prioritizing investment in targeted renovations, strategic and thoughtful new construction and essential infrastructure upgrades to strengthen the foundation for excellence in research and student success.
- Improving learning environments will foster a more accessible, cohesive and welcoming K-State, strengthening campus communities for future innovation.



PROMOTE STEWARDSHIP & RESILIENCY

- Ongoing, data-informed decisions will pave the way for a more resilient, efficient, and forward-looking future.
- Modernizing infrastructure and optimizing existing facilities will aid K-State in advance sustainability goals while reducing long-term costs and environmental impact.

CAMPUS VISION MANHATTAN

The Manhattan Campus vision focuses on renewing existing facilities, adding strategic new buildings, and identifying future growth areas—all while strengthening the campus core and improving connectivity.

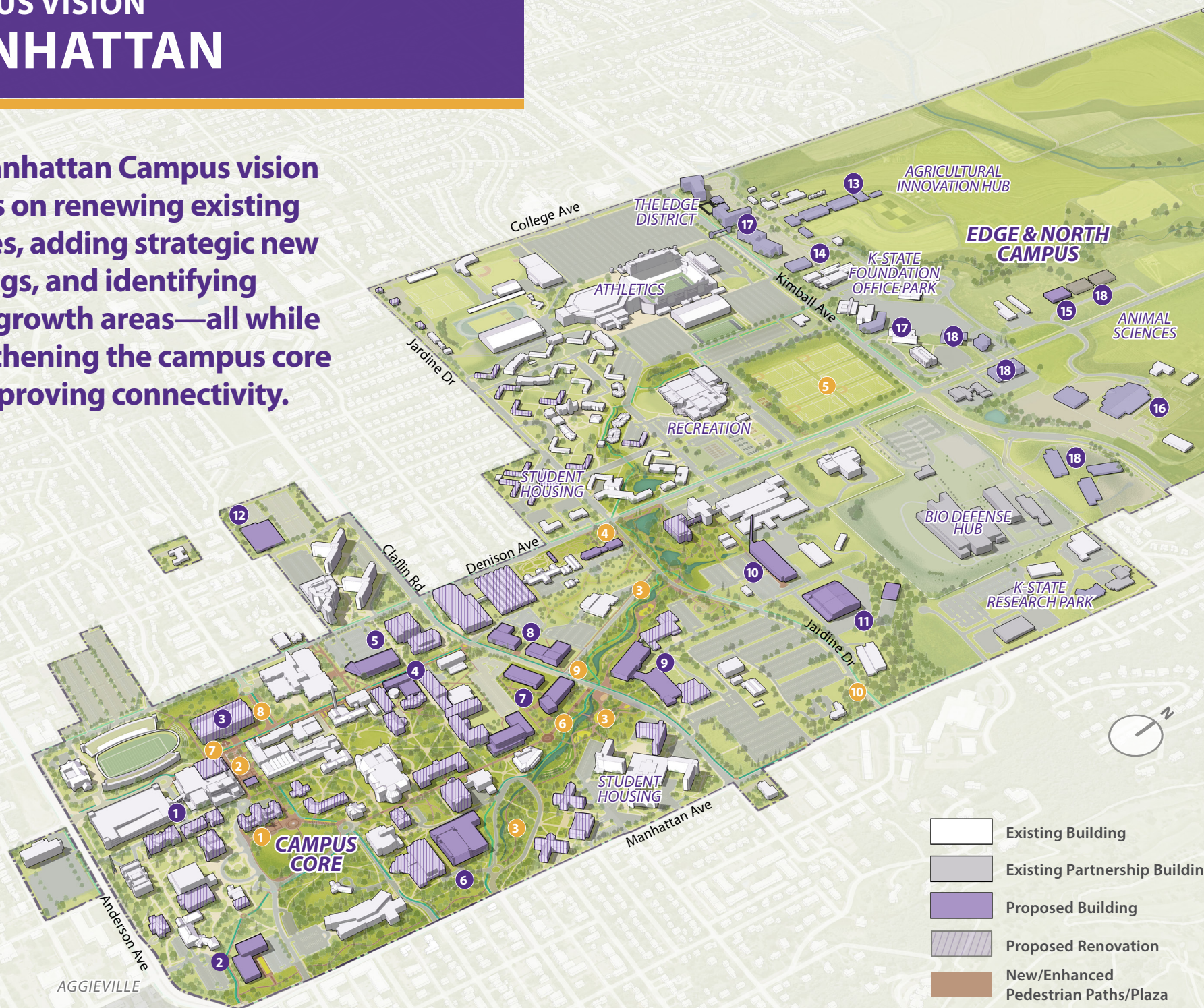

Strategic Capital Projects

- 1 Kedzie Hall South transformation
- 2 Interdisciplinary Arts Center
- 3 Ahearn Convention & Events Center
- 4 Ward Hall Nuclear Research renovation & replacement
- 5 Applied Learning High-Bay
- 6 Integrated Wellness Building & Parking Structure
- 7 Integrated Research Catalyst Sites
- 8 Integrated Research Future Sites
- 9 Global Center for Grain & Food Innovation
- 10 Kansas Veterinary Diagnostics Lab
- 11 University Receiving & Storage
- 12 Housing & Dining Services Refrigeration & Storage
- 13 Agronomy Research & Innovation Center
- 14 Edge Tech Incubator
- 15 Large Equipment High-Bay
- 16 Bilbrey Family Event Center
- 17 The Edge Champions Gate
- 18 Future Opportunity Sites

Site & Landscape Improvements

- 1 Anderson Lawn transformation
- 2 Bosco Student Plaza revitalization
- 3 Campus Creek transformation
- 4 K-State Gardens transformation
- 5 Turf Recreation Fields
- 6 Mid-Campus Drive pedestrianization
- 7 M.L.K. Jr. Drive transformation
- 8 College Heights Road pedestrianization
- 9 Clafin Road improvements
- 10 Jardine Drive extension

FOCUS AREAS OF TRANSFORMATION

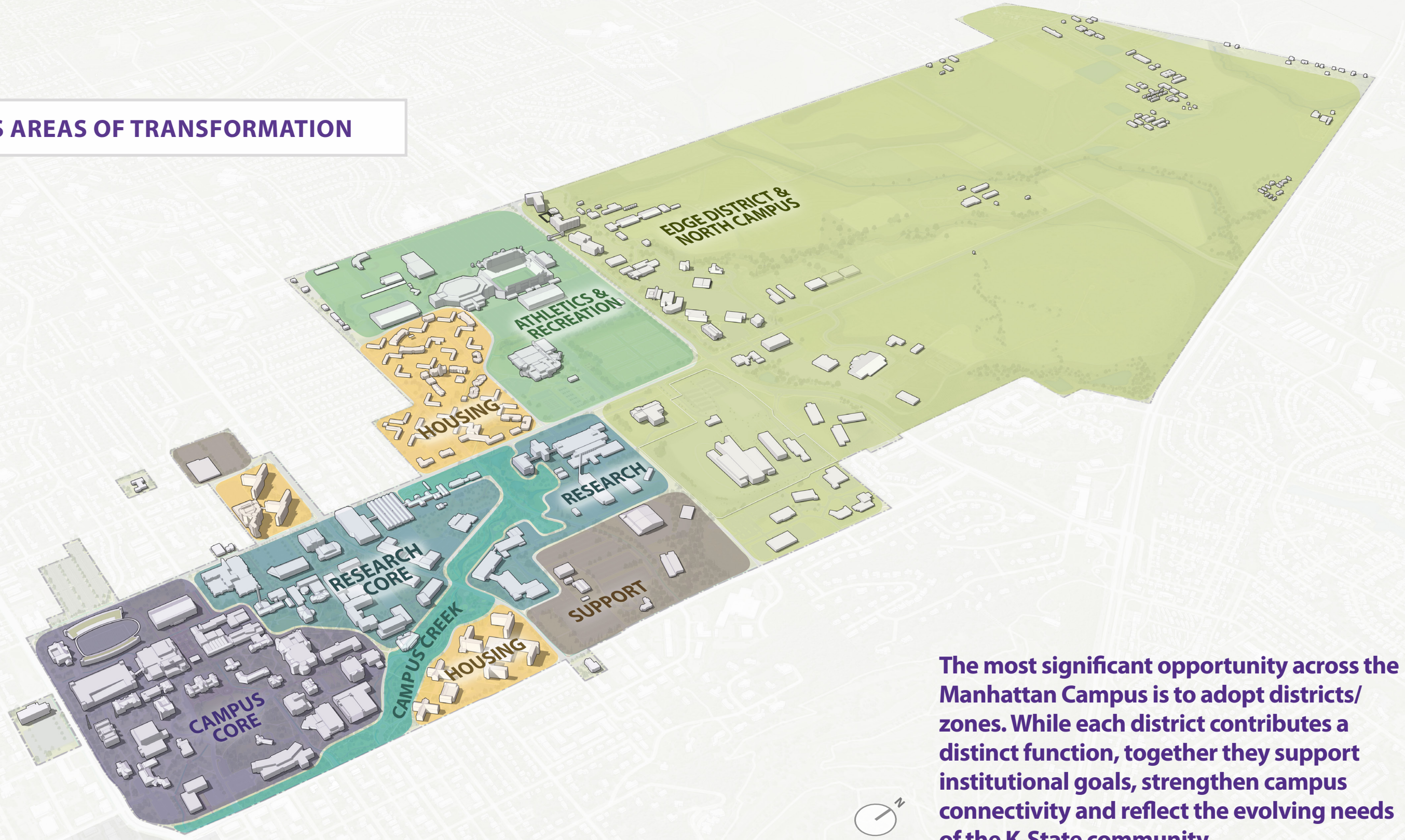

The most significant opportunity across the Manhattan Campus is to adopt districts/zones. While each district contributes a distinct function, together they support institutional goals, strengthen campus connectivity and reflect the evolving needs of the K-State community.

CAMPUS CORE IMPROVEMENTS

Heritage-Rich Spaces Reimagined for a Connected Future

Improvements in the campus core emphasize revitalizing the heart of the university through several facility renovation projects. These initiatives primarily target existing buildings, many of which hold historic and cultural significance, preserving their legacy while adapting them for modern use. The plan also prioritizes enhancing connectivity across campus, expanding the pedestrian experience to promote safety and accessibility. Key public spaces—such as plazas, lawns and gateways—are being thoughtfully reimagined as a more welcoming, cohesive and vibrant environment that reflects the university's identity.

- ① Kedzie Hall South transformation
- ② Kedzie Hall North renovation
- ③ Ahearn Convention & Events Center
- ④ Student Union Ballroom & 2nd Floor renovation
- ⑤ Anderson Hall renovation
- ⑥ Holtz Hall renovation
- ⑦ Eisenhower Hall renovation
- ⑧ Fairchild renovation
- ⑨ MLK Jr. Drive & College Heights Road transformation
- ⑩ Mid-Campus Drive pedestrianization
- ⑪ Bosco Student Plaza revitalization
- ⑫ Anderson Lawn transformation
- ⑬ Memorial Stadium connection

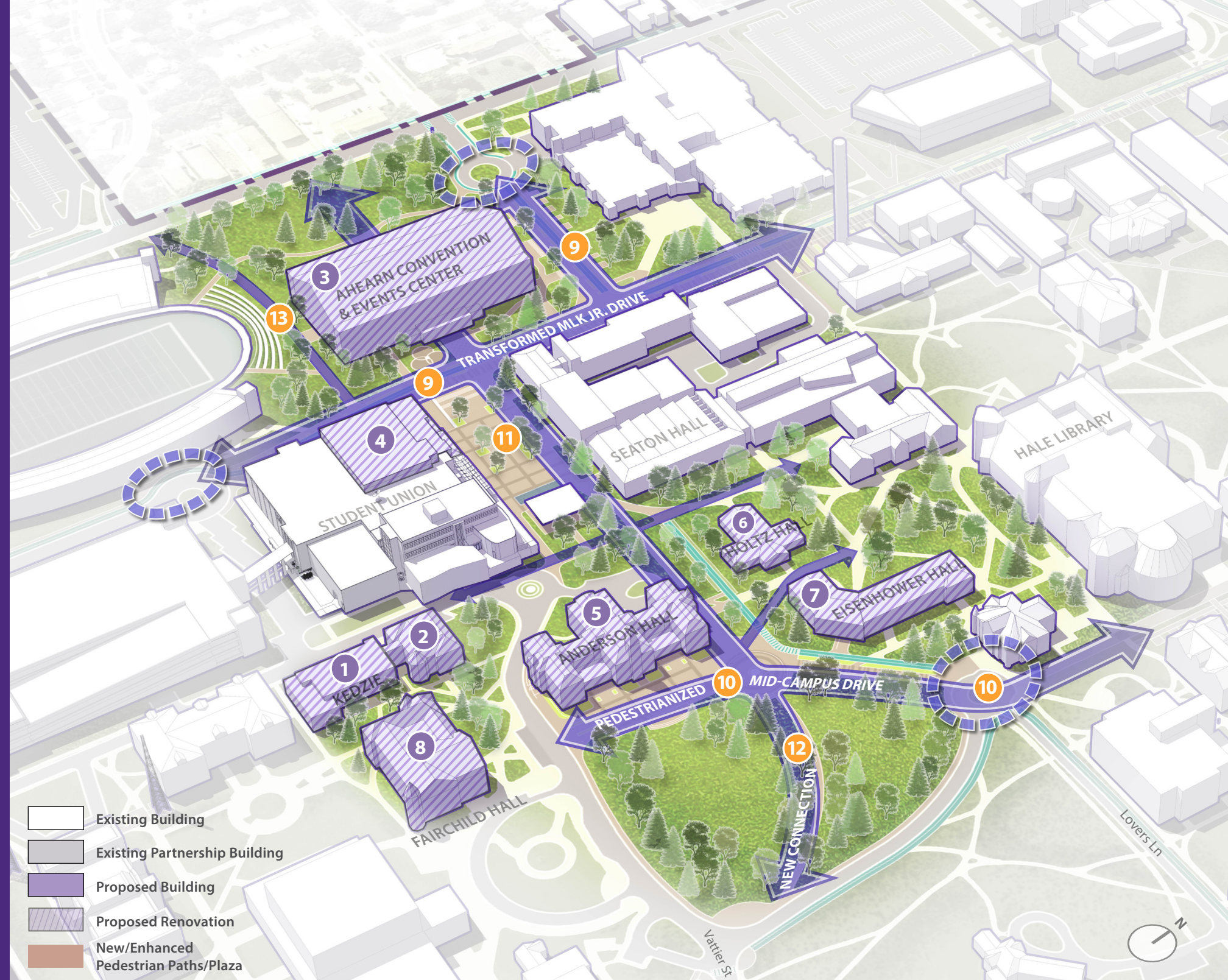

ANDERSON HALL & LAWN TRANSFORMATION

K-State is investing to preserve and restore Anderson Hall, spawning a revitalization of the historic campus core. The project will enhance accessibility, update infrastructure and create more functional, welcoming spaces—while preserving the building's iconic campus presence.



AFTER: ANDERSON HALL & PEDESTRIANIZED MID-CAMPUS DRIVE PLAZA

CURRENT: ANDERSON HALL & LAWN

AHEARN TRANSFORMATION

Renovating historic Ahearn Field House into a vibrant, multi-purpose convention and event center honors its legacy and reimagines it as a dynamic hub for social gatherings, community events, demonstrations and shared experiences that unite people.



AFTER: EVENT INTERIOR

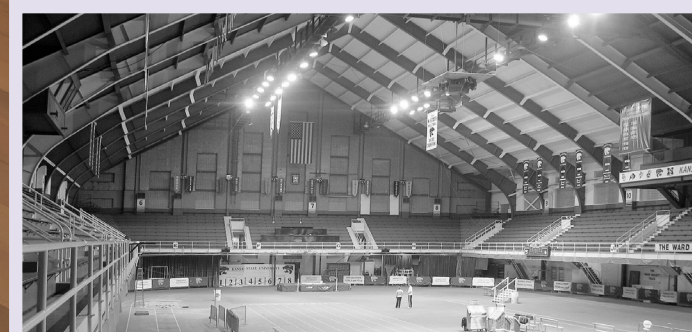

CURRENT: AHEARN FIELD HOUSE

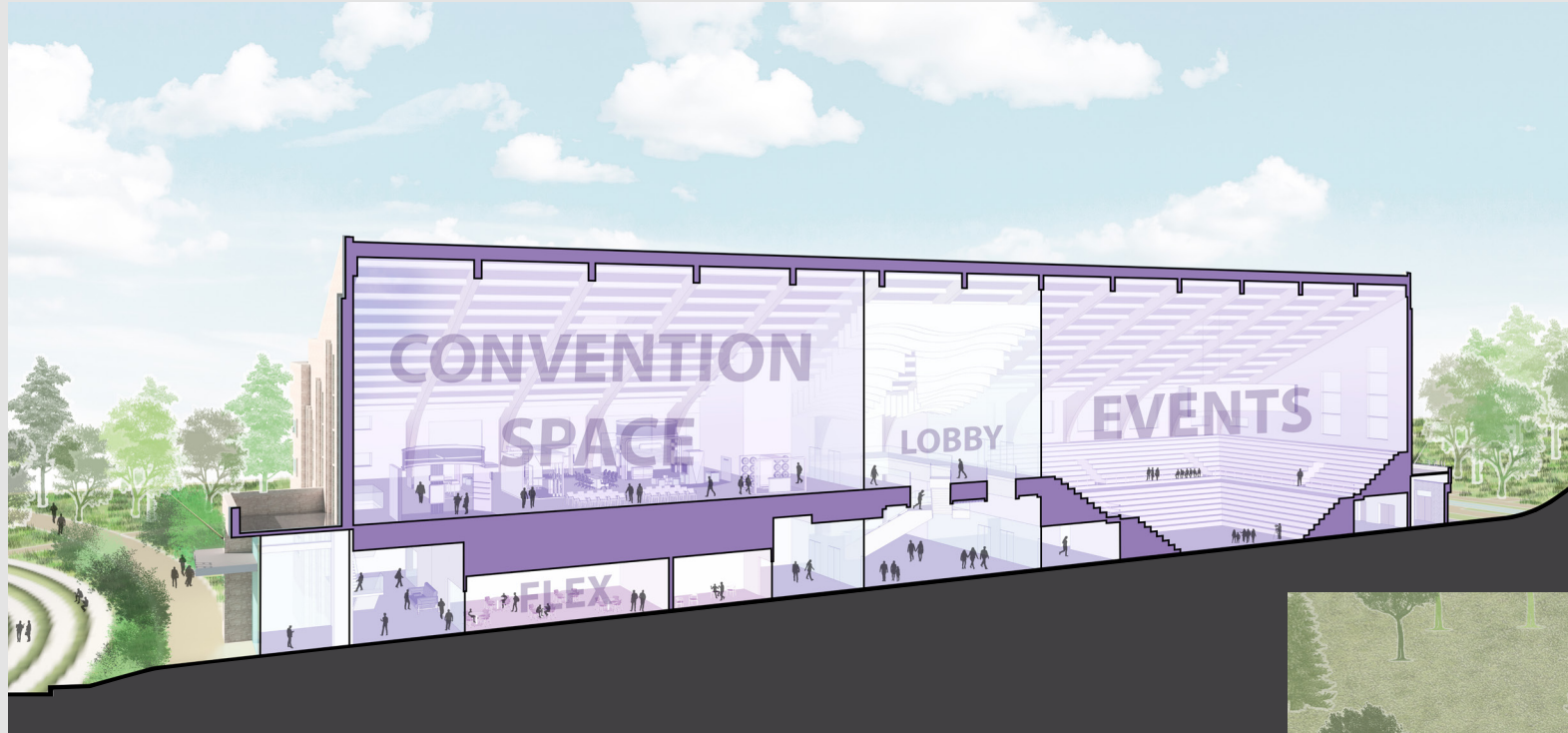

AHEARN FIELD HOUSE SECTION FACING WEST

A Legacy Space for the Next Generation

Rooted in history, Ahearn has welcomed iconic figures such as Dr. Martin Luther King Jr. and has been home to legendary basketball and track events. The revitalized space honors this legacy while creating a vibrant, accessible environment for future generations to gather, learn and lead.

The reimagined multi-purpose event center is designed with flexibility—capable of hosting graduations, TED-style talks, Landon Lectures, large class sessions and distinguished university guests. This dynamic space will serve as a cornerstone for cultural and community engagement at K-State.

The upper-level convention space is designed with adaptability in mind and will serve as a key venue for career fairs, student organization functions, and university-hosted events that align with the building's broader event offerings. On the first floor, a series of flexible-use rooms will provide additional capacity for meetings, workshops and collaborative activities, reinforcing Ahearn's role as a versatile and inclusive space that supports both academic and extracurricular life.

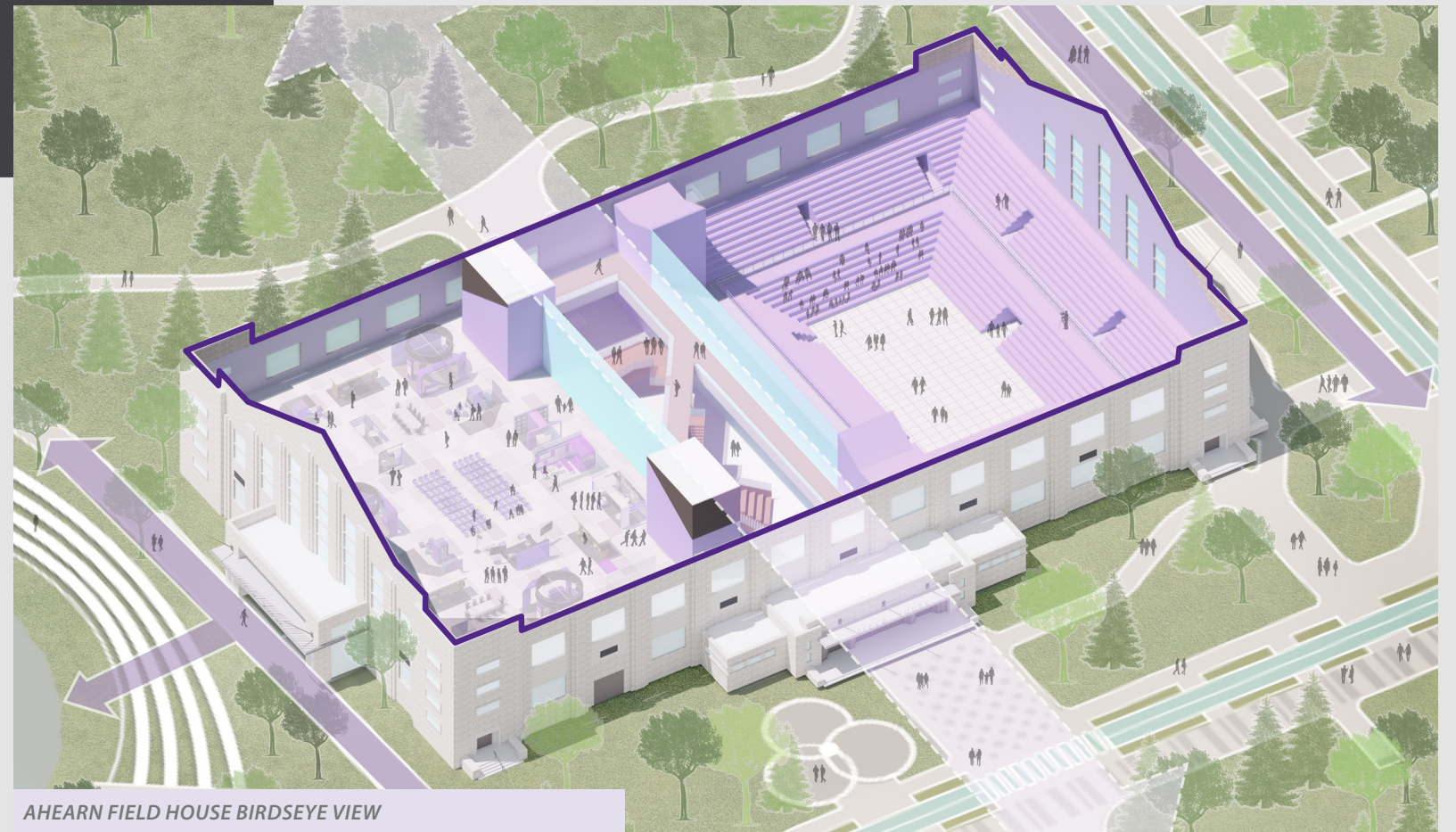

AHEARN FIELD HOUSE BIRDSEYE VIEW

BOSCO STUDENT PLAZA TRANSFORMATION

Reimagined as a more open, accessible and inviting place, a reimagined Bosco Student Plaza includes removing barriers, improving sightlines and introducing new social and engagement spaces. Serving as a new front door for visitors, prospective students and university guests, this redesign also creates opportunities for K-State branding to strengthen campus identity.



AFTER: BOSCO STUDENT PLAZA REIMAGINED



CURRENT: BOSCO STUDENT PLAZA AT MLK JR. DRIVE

CAMPUS CREEK TRANSFORMATION

Connecting Campus, Nature & Discovery

Extending from Aggieville to the Agricultural Research areas, the Campus Creek is envisioned as a vibrant ecological spine, offering a rich diversity of landscape typologies that support learning, recreation and connectivity. These enhancements also strengthen the connections between campus and the community, offering new spaces for respite and well-being. They also highlight the creek as a central, unifying feature that links key destinations and reflects the university's commitment to education, research, community and sustainability.

Plans include outdoor classrooms nestled within natural settings, expanded access to the K-State Gardens and improved pedestrian crossings at major streets to ensure safe, seamless movement across campus. The corridor will feature a mix of campus forest, restored prairie zones and open green spaces, creating a dynamic and immersive natural environment.

- 1 Campus Gateway
- 2 Outdoor Classroom
- 3 Wellness Garden
- 4 Outdoor Living Laboratory
- 5 K-State Gardens
- 6 Multipurpose Pathways
- 7 Active Recreation



CAMPUS CREEK TRANSFORMATION

Transformation of the Campus Creek corridor will improve an underutilized resource, connecting the campus community with opportunities for recreation, places to commune and a variety of landscapes to experience from open green space to forested canopies and tall grass prairies.



AFTER: CAMPUS CREEK FACING SOUTH TOWARD THE LEADERSHIP STUDIES BUILDING



BEFORE: CAMPUS CREEK FROM OLD CLAFLIN ROAD

RESEARCH CORE IMPROVEMENTS

Powering Discovery: Building a Bold Research Future

K-State is advancing applied learning and research through specialized, high-impact spaces that support innovation and collaboration.

Strategic renovations to core facilities like Waters, Cardwell, Ackert, Throckmorton, and Ward Halls, along with expansion along MLK Jr. Drive and Claflin Road, are transforming this campus neighborhood into a cohesive, future-ready research district. These investments will not only modernize infrastructure but also create the conditions for groundbreaking discovery, collaboration and workforce development.

- ❶ Integrated Research Catalyst Sites
- ❷ Integrated Research Future Sites
- ❸ Ward Hall Nuclear Research renovation & replacement
- ❹ Applied Learning High-Bay
- ❺ Waters Hall renovation
- ❻ Cardwell Hall renovation
- ❼ Ackert/Chalmers Hall renovation
- ❽ Throckmorton Hall renovation
- ❾ Reconfigured Parking & Service Area
- ❿ Research Gateway & Plaza
- ⓫ Pedestrian Crossing improvement



INTEGRATED RESEARCH HUB

From a new Integrated Research Hub and Integrated Nuclear Research Center, to the Edge Tech incubator and the state-of-the-art Kansas Veterinary Diagnostics Lab, these research-driven projects are strategically aligned to propel the university’s land-grant mission and elevate its R1 aspirations.



CURRENT: VIEW OF PARKING LOT A17 & WATERS HALL

AFTER: A VIBRANT, NEW, RESEARCH HUB

STUDENT SERVICES RESOURCE NETWORK

One K-State: Reimagining Student Support

K-State is enhancing the student experience by consolidating academic, enrollment and well-being services into three centralized, accessible one-stops. This integrated model seeks to improve coordination, strengthen relationships and make essential resources easier to navigate.

Key locations include Hale Library for academic support, Kedzie Hall South for enrollment and financial services and a new integrated wellness facility near Justin Hall that brings health and counseling closer to students and related academic programs. Together, these efforts create a more connected and student-centered campus.

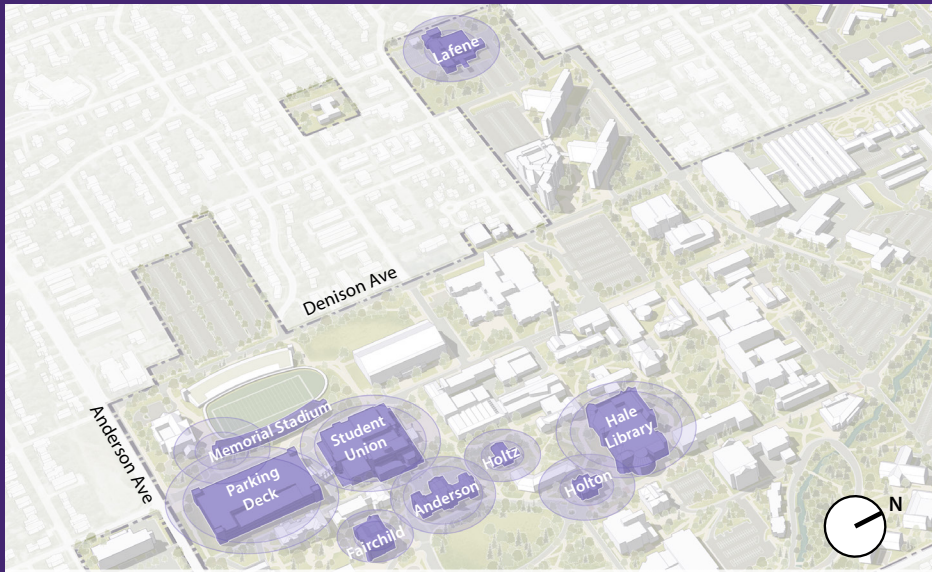

Existing Conditions:
A fragmented network of facilities offering student support

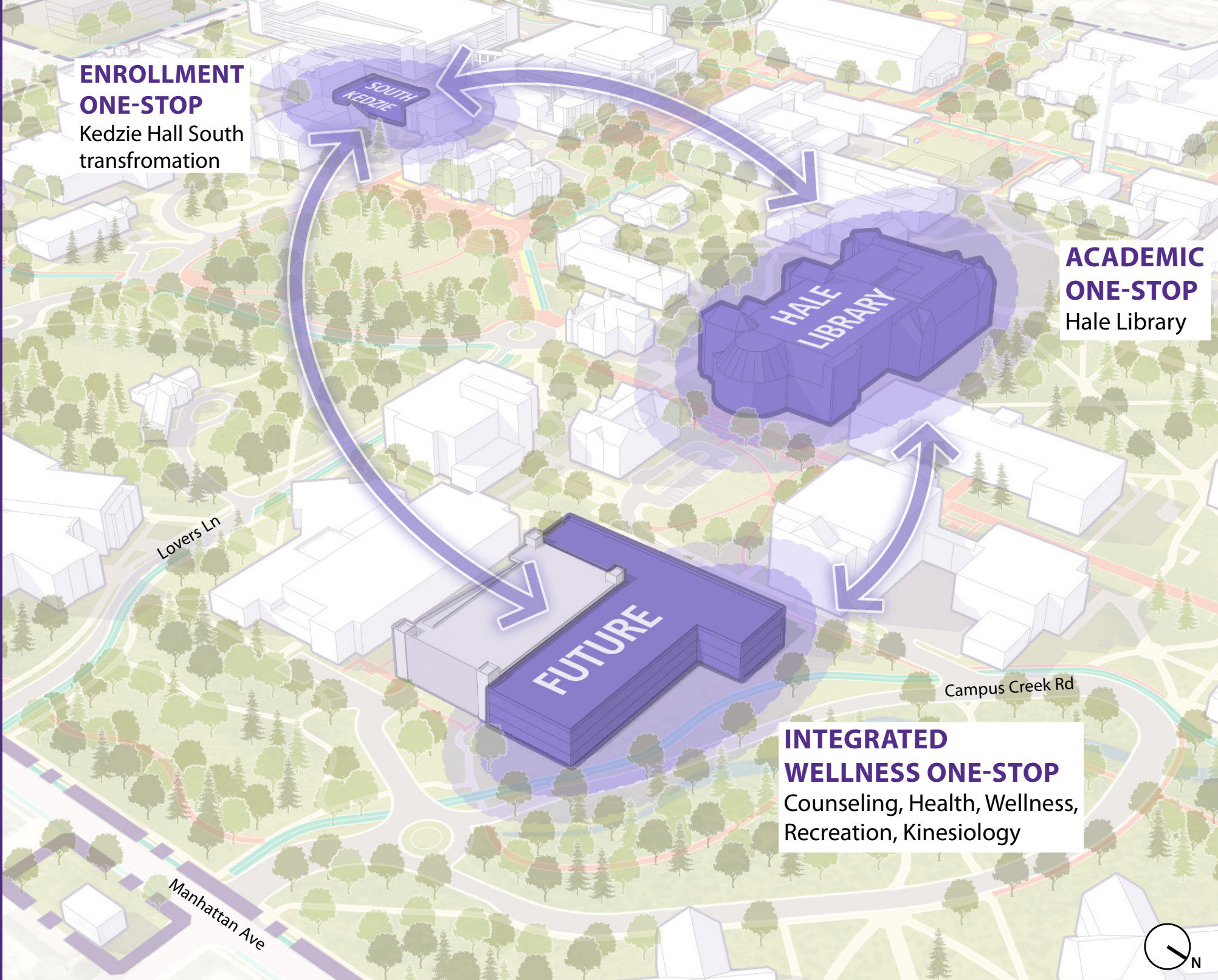

INTEGRATED WELLNESS BUILDING

A new Integrated Wellness building brings together health, counseling, and associated wellness and clinical programs in a more accessible location, enhancing the student experience through coordinated care and easier access to essential resources.



AFTER: ONE-STOP STUDENT SERVICES WITH CAMPUS CORE IN BACKGROUND



CURRENT: VIEW OF CAMPUS CREEK COMPLEX & LOT A5

THE EDGE DISTRICT & NORTH CAMPUS

A Gateway of Opportunity

The Edge District is a dynamic zone of growth and innovation at the edge of the Manhattan Campus, serving as a vital link between K-State, corporate partners, industry partners and the broader community. The Next-Gen Campus Master Plan builds on the existing framework, aligning with prior planning and community initiatives to create a cohesive vision. Through collaboration with university stakeholders and local partners, the plan integrates ongoing projects, infrastructure strategies and land-use goals—including adjacent agricultural research programs—to amplify the district's potential. This coordinated approach reinforces its role as a gateway and positions it as a catalyst for innovation, collaboration and long-term vitality.

- ① Future Opportunity Sites
- ② Large Equipment High-Bay
- ③ Bilbrey Family Event Center
- ④ Event Center Support
- ⑤ Edge Tech Incubator
- ⑥ The Edge Champions Gate
- ⑦ Agronomy Research & Innovation Center

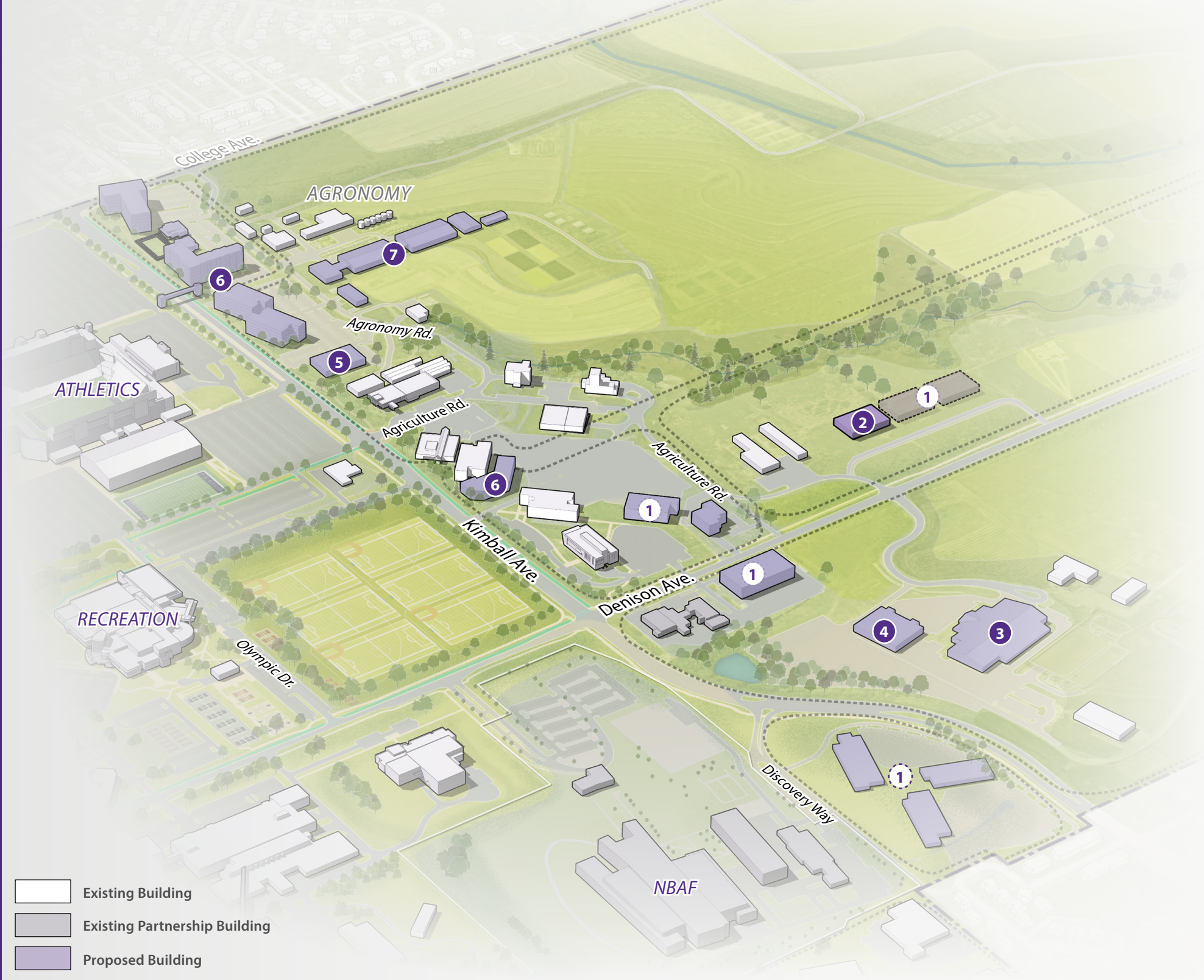

CAMPUS VISION SALINA

K-State Salina's vision responds to community feedback calling for a stronger sense of place, improved cohesion and more social spaces. With development and investment already underway, this is a pivotal moment to unify efforts as a future-focused campus that supports learning, collaboration and community.



CAMPUS VISION OLATHE

The K-State Olathe Innovation Campus serves as the university's front door to greater Kansas City, advancing K-State's land-grant mission through education, research and industry partnerships. Positioned for strategic growth, it responds to evolving academic and workforce needs.

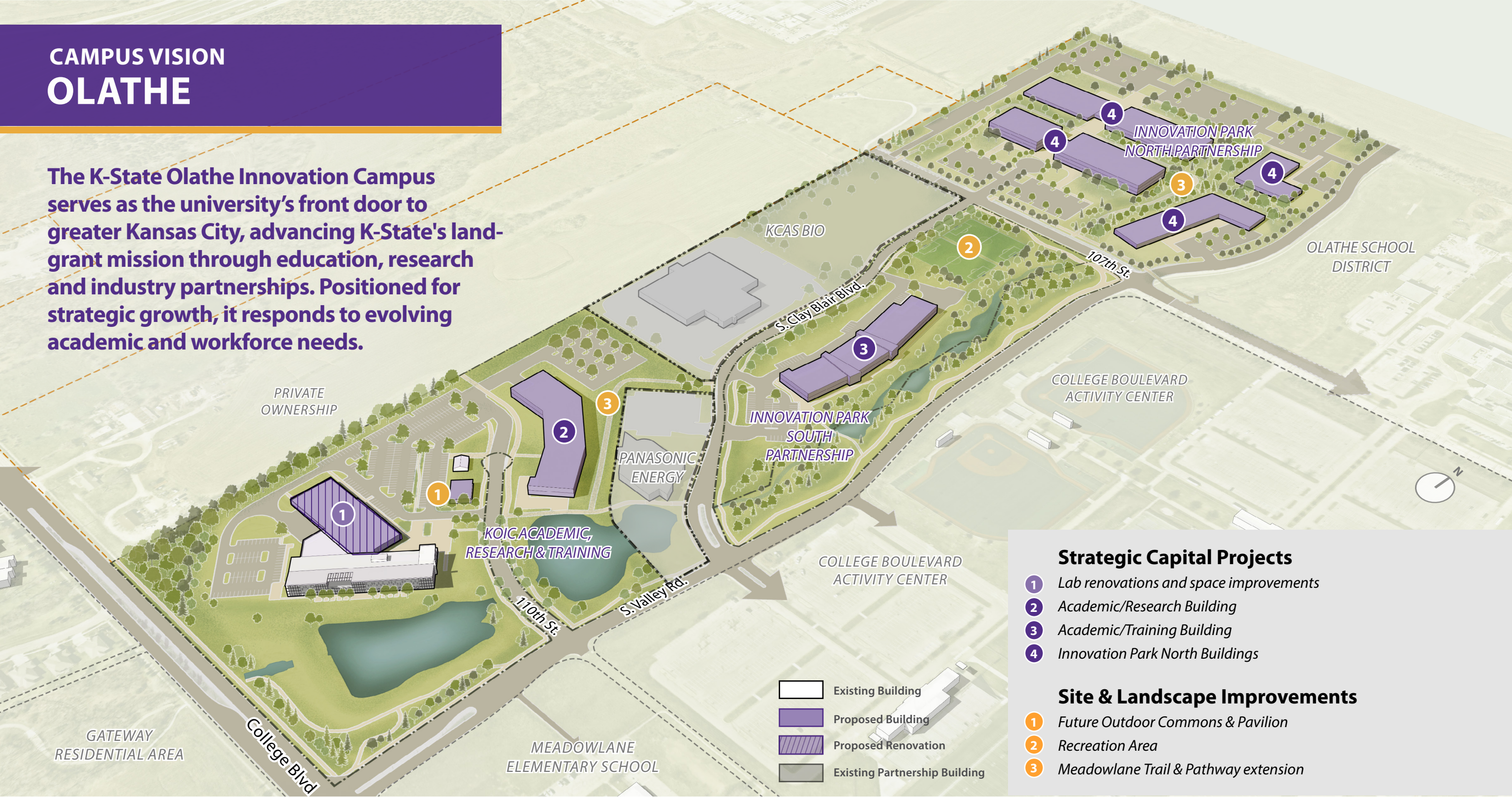

Strategic Capital Projects

- 1 Lab renovations and space improvements
- 2 Academic/Research Building
- 3 Academic/Training Building
- 4 Innovation Park North Buildings

Site & Landscape Improvements

- 1 Future Outdoor Commons & Pavilion
- 2 Recreation Area
- 3 Meadowlane Trail & Pathway extension

BEYOND THE VISION: ENABLING ENDURING CHANGE

This plan is more than a blueprint for physical transformation—it calls for deep, system-wide change that is essential to the plan's success. Achieving this vision requires reimagining policies, streamlining operations and making strategic investments in both infrastructure and people. These foundational efforts demand focused attention, long-term commitment and a shared sense of responsibility across the K-State community.

RE-IMAGINE TEACHING & APPLIED LEARNING SPACES

Campus learning environments will be transformed to support future pedagogies and foster instructional innovation. While current teaching space is sufficient to accommodate projected enrollment growth, these environments should be repositioned to reflect how students learn best. Enhancing these spaces also supports faculty development by enabling more flexible, technology-rich settings that encourage experimentation and collaboration in teaching.

INCREASE SUPPLY OF RESEARCH SPACE

To achieve the goal of significantly increasing research activity, particularly cutting-edge research at the intersection between various disciplines, we need an additional 200K GSF to meet our Next-Gen research goals. Space that is not permanently assigned to a specific research initiative, but rather has flexible governance and flexible space that can bring together interdisciplinary researchers and teams to advance collaboration.

ADVANCE CAMPUS MOBILITY

As the university continues to expand and evolve, mobility is emerging as a critical component of campus planning. The potential reduction in long-term parking capacity due to new development underscores the need for a comprehensive transportation and parking demand management strategy—one that prioritizes accessibility, sustainability and adaptability. This planning initiative presents a timely and strategic opportunity to engage the broader K-State community to shape the future for a potential future-ready mobility solution.

STUDENT SERVICES

Wrap-around student support includes providing easy and convenient access to academic, administrative and well-being resources. By co-locating these functions in highly visible locations we not only enhance the students experience but also the potential for success.

LEGACY BY DESIGN: BUILT FOR A CENTURY & BEYOND

We will plan, design and build resilient, adaptable, and energy-efficient facilities designed to last a century—engineered with flexible systems, modular components, and sustained through rigorous preventive care to serve generations of future Wildcats.

HEALTH & WELL-BEING

Improving student and community well-being is at the forefront of our strategic imperatives. A new integrated wellness building will help us achieve this critical vision for our students, faculty and staff bringing together health and counseling services in our first purpose-built facility for these services.

APPLYING UPDATED UNIVERSITY SPACE GUIDELINES

Applying updated university space guidelines to office space confirms that K-State has sufficient capacity to support projected growth. Workspace planning continues to evolve in response to changing work patterns, with real-time space utilization tools enabling data-informed decisions. These insights should guide updates to existing office spaces during renovations to ensure alignment with evolving standards.

STREAMLINING GOVERNANCE FOR GREATER IMPACT

To ensure timely and strategic progress, decision-making processes for capital requests must be streamlined and aligned with institutional priorities. Strengthening governance structures and improving coordination across units will reduce duplication, enhance transparency and ensure that resources are directed where they can have the greatest impact.

ACKNOWLEDGMENTS

EXECUTIVE LEADERSHIP

Richard H. Linton, *President*
R. Marshall Stewart, *Executive VP for External Engagement & Chief of Staff*
J.P. Mendez, *Provost and Executive VP*
Thomas Lane, *VP for Academic Success & Student Affairs / Dean of Students*
Ethan Erickson, *VP for Administration and Finance*
Alysia Starkey, *CEO & Dean of Salina Campus*
Debbie Mercer, *Former Interim Provost and Executive VP & Dean of the College of Education*

STEERING COMMITTEE

Chad Bristow, *KBOR Director of Facilities*
Hans Coetzee, *VP for Research*
Christopher Culbertson, *Professor & Dean of Arts and Sciences*
Derek Jackson, *Associate Vice President of Community Building & Director of Housing & Dining Services*
Cassandra Jones, *Professor in Animal Sciences & Industry*
Shabina Kavimandan, *Assistant Professor of Curriculum & Instruction*
Greg Lohrentz, *K-State Foundation Senior VP of Operations & Finance*
David Rosowsky, *Former VP for Research*
Bonnie Rush, *Dean College of Veterinary Medicine*
Jane Schuh, *College of Agriculture, Associate Dean of Research & Graduate Programs/Associate Director of Research & Technology Transfer*
Ben Stark, *College of Arts & Sciences, Dean for Infrastructure & Faculty Support*
Gene Taylor, *Athletic Director/Intercollegiate Athletics*
Caleb Stout, *FY23-24 Student Body President*
Paige Vulgamore, *FY24-25 Student Body President*
Corey Williamson, *Assistant VP Organizational Culture & Employee Experience*
Patrick Winter, *Associate Vice Provost for Enrollment & Executive Director for Recruitment & Admissions*

SALINA LEADERSHIP

Alysia Starkey, *CEO & Dean of Salina Campus*
Michael James, *Executive Director of Administration & Finance*
Kirsten Regan, *Former Executive Director of Strategic Initiatives*

OLATHE LEADERSHIP

Ben Wolf, *CEO & Dean of Olathe Innovation Campus*
Meagan Sadler, *Former Director of Budgets & Financial Services*
Shabina Kavimandan, *Assistant Professor of Curriculum & Instruction*

FACILITIES TEAM

Casey Lauer, *Associate VP for Facilities*
Lisa Johnson, *Assistant VP - Planning, Design & Construction*
Christopher Salmon, *Assistant VP - Operations & Infrastructure*
Tim Brunner, *Director - Utilities & Plant Management*
Rosanna Carvalho, *Director - Planning, Design & Construction*
Heather Mills, *Director - Space Management*
Adrienne Tucker, *Director - Parking Services & Transportation*
Gary Weishaar, *Director - Business & Operations Strategy*
Tim DeNoble, *Former Dean, College of Architecture, Planning & Design*

MARKETING & COMMUNICATIONS TEAM

Christine Doucette, *Communications Strategist for Administration & Finance*
Vikki Watson, *Communications Manager for Administration & Finance*
Rebecca Gould, *Director of Strategic Projects for Administration & Finance*

CONSULTANT TEAM

SmithGroup, *Lead Planning*
HNTB, *Mobility & Transportation*
Olsson, *Civil Engineering*

STAKEHOLDER GROUPS

- **Academic**
 - o College of Agriculture
 - o College of Architecture, Planning & Design
 - o College of Arts & Sciences
 - o College of Business Administration
 - o College of Education
 - o College of Engineering (Carl R. Ice)
 - o College of Health & Human Sciences
 - o College of Technology & Aviation
 - o College of Veterinary Medicine
 - o Faculty Senate Committee on University Planning
 - o Graduate School
 - o K-State Libraries
 - o K-State Olathe
 - o Research
- **Administration**
 - o Alumni & Foundation
 - o Communication & Marketing
 - o Enrollment Services
 - o Facilities & Grounds
 - o Finance
 - o Health & Well-being / Recreation
 - o Human Resources & Staffing
 - o Information Technology
 - o Professional Staff Affairs
 - o Risk Management-Legal
 - o Student Life & Government
 - o Sustainability
 - o Transportation & Parking
- **Athletics**
- **Local & Regional Community Organizations**
 - o City of Manhattan Chamber of Commerce
 - o Flint Hills Regional Council & ATA Bus
 - o Friends of K-State & Philanthropy
 - o Pott County / Riley County
- **Partnerships**
 - o Local, State, & Federal Partners
 - o Business & Industry
 - o U.S. Food & Drug Administration
 - o Kansas Water Institute



SMITHGROUP